

## Part Numbers

### Fixture

4232- Dream Beam Nine

## Mechanical Specifications

Housing: Stainless Steel  
 Connection: Cable mounted Cat 5 head  
 Accessories: Cat 5 Splitter (included)  
 Cat 5 cable 5 meter (included)  
 MR16 nickel housing  
 8CM Frosted tube with adapter ring  
 20CM Frosted tube with adapter ring  
 120CM Frosted tube with dual adapter ring

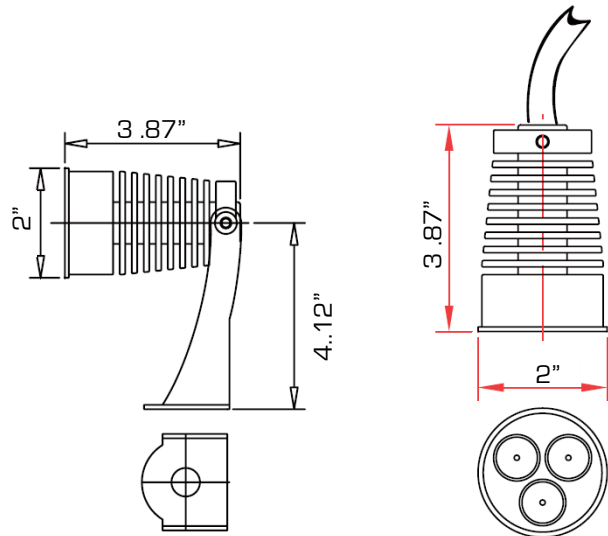

Fixture	Packaged for Shipping
Size: 2" x 3.87"	Size: 8.25"L x 3.25"W x 3.25"H
Weight: 1lbs	Weight: 2 lbs

## LED Specifications

LED Quantity: 3  
 LED Type: Tri Color R,G,B  
 LED Watts: 3 Watts each  
 LED Lifetime: 50 to 100 thousand hours  
 LED Angle: 45° ( ± 5° )

## Control

Dream Drive can control 4 Dream Beam Nine.

Dream Drive Quad can control 16 Dream Beam Nine 4 per zone

